

SRI MAYURA GARDEN

PLAN SHOWING THE PROPOSED LAYOUT OF HOUSE SITE IN
 S.F.NO. 491/3A2,3B2, 492/4B AT VAZHAMPALAYAM COIMBATORE - NORTH,
 COIMBATORE - TALUK & DISTRICT

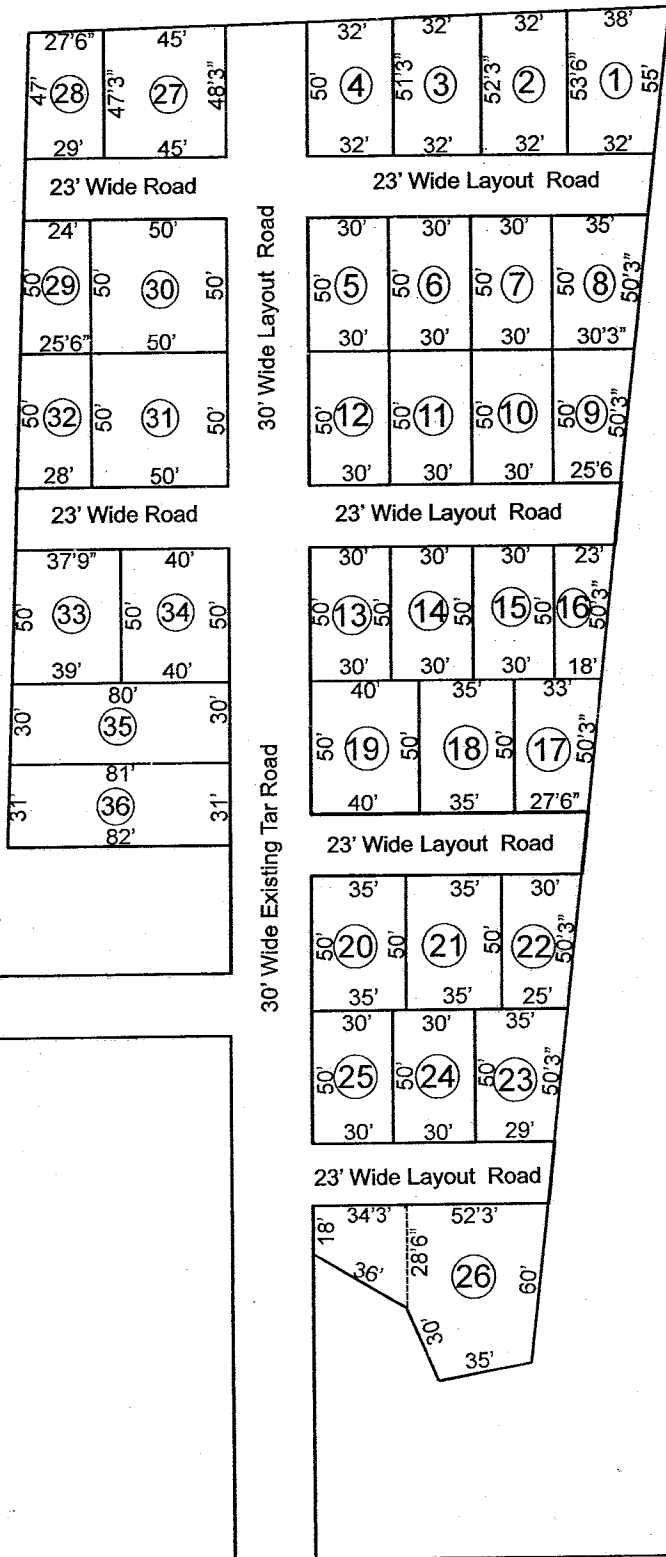

Site No.	Total sqft	Cents	sqft
1	1899	4	156
2	1692	3	385
3	1656	3	349
4	1620	3	313
5-7	1500	3	193
8	1635	3	328
9	1397	3	90
10-15	1500	3	193
16	983	2	112
17	1516	3	155
18	1750	4	7
19	2000	4	257
20-21	1750	4	7
22	1378	3	71
23	1604	3	297
24-25	1500	3	193
26	3400	7	351
27	2149	4	406
28	1331	3	24
29	1237	3	30
30	2500	5	322
31	2500	5	322
32	1337	3	130
33	1918	4	200
34	2000	4	257
35	2415	5	237
36	2511	5	333

Total Land Area = 2 Acres

Site Area = 1.44 Acres

Road Area = 56 Cents

Covai to Sathy & Mysore Main Road NH 209